

Threaded Adapter

Adapter & Bushing

GCM: Male Straight Thread x Male Pipe

Connects female SAE/MS to female NPT thread

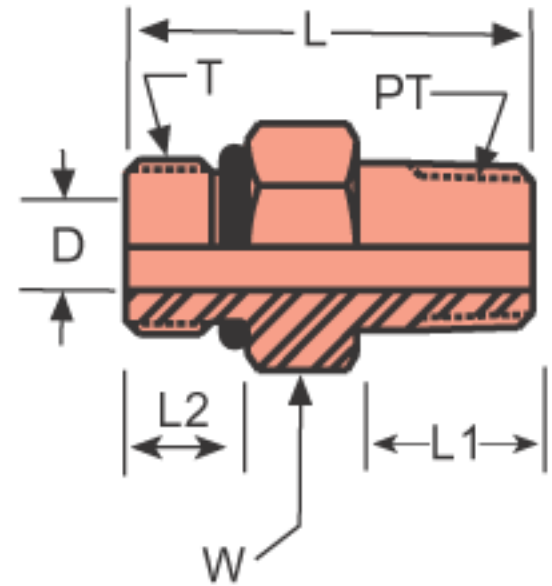

* Working Pressures

Part Number	T Thread	PT Pipe Thread	D Through Hole	L	L1	L2	W Hex	Stainless Steel*	Monel*	Brass*
4X1/8GCM	7/16 - 20	1/8 - 27	0.19	1.07	0.38	0.30	9/16	6000	---	---
4X1/4GCM	7/16 - 20	1/4 - 18	0.20	1.24	0.56	0.36	9/16	6000	---	---
5X1/4GCM	1/2 - 20	1/4 - 18	0.28	1.24	0.56	0.36	5/8	6000	---	---
6X3/8GCM	9/16 - 18	3/8 - 18	0.30	1.30	0.56	0.39	11/16	6000	---	---
6X1/4GCM	9/16 - 18	1/4 - 18	0.28	1.30	0.56	0.36	11/16	6000	---	---
8X3/8GCM	3/4 - 16	3/8 - 18	0.41	1.37	0.56	0.39	7/8	6000	---	---
8X1/2GCM	3/4 - 16	1/2 - 14	0.42	1.56	0.75	0.44	7/8	6000	---	---
8X3/4GCM	3/4 - 16	3/4 - 14	0.42	1.59	0.75	0.59	1-1/8	4800	---	---
10X1/2GCM	7/8 - 14	1/2 - 14	0.50	1.69	0.75	0.44	1	5400	---	---
12X3/4GCM	1-1/16 - 12	3/4 - 14	0.66	1.75	0.75	0.59	1-1/4	4800	---	---
16X3/4GCM	1-5/16 - 12	3/4 - 14	0.72	1.89	0.75	0.59	1-1/2	3600	---	---
16X1GCM	1-5/16 - 12	1 - 11-1/2	0.84	1.90	0.94	0.59	1-1/2	3600	---	---
20X1-1/4GCM	1-5/8 - 12	1-1/4 - 11-1/2	1.09	2.17	0.97	0.59	1-7/8	3000	---	---
24X1-1/2GCM	1-7/8 - 12	1-1/2 - 11-1/2	1.34	2.28	1.00	0.59	2-1/8	2400	---	---