

# Threaded Adapter

## Adapter & Bushing

### GCU-BSPP: BSP Straight Thread Union

Connects female ISO parallel thread

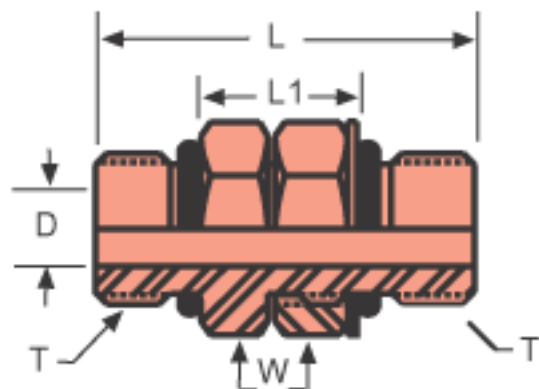

\* Working Pressures

Part Number	T Thread BSPP	D Through Hole	L	L1 After Ass'y	W Hex	Stainless Steel*	Monel*	Brass*
4GCU-BSPP	1/4 - 19	0.23	1.54	0.63	3/4	6000	---	---
6GCU-BSPP	3/8 - 19	0.30	1.69	0.78	7/8	6000	---	---
8GCU-BSPP	1/2 - 14	0.48	2.22	1.07	1-1/8	6000	---	---
12GCU-BSPP	3/4 - 14	0.66	2.28	1.13	1-3/8	4800	---	---
16GCU-BSPP	1 - 11	0.84	2.68	1.11	1-3/4	3600	---	---

DIN-ISO 228/1, JIS B0202, BS 2779