

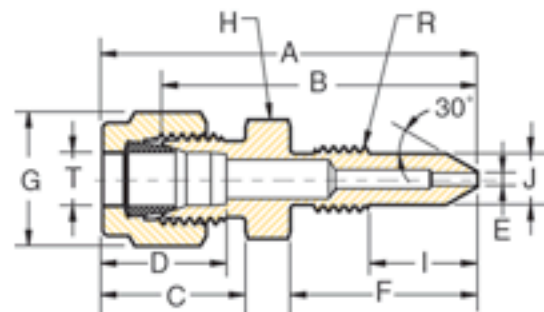

Tube Stub Connectors/Adapters

U-CU1: Calibration Union

SSP Instrumentation Calibration Unions streamline the typical DP transmitter calibration process and are available in 1/4" OD tubing by 1/4-28 straight thread, and 1/4" OD tubing by 5/16-24 straight thread. Calibration Unions screw directly into plug/bleed port fittings, eliminating the possibility of galling the transmitter's NPT threads.



* Working Pressures

Part Number	T Tube O.D.	A	B	C	D	E Min. Opening	F	G	H	I	J	R	Stainless Steel*	Brass*
U4CU1	1/4	1.69	1.40	0.70	0.60	0.06	0.78	9/16	1/2	0.43	0.20	1/4-28 UNF	---	---

Finger-tight assembly dimensions (shown in inches) are for reference only and subject to change. When ordering, specify material designator with part number. Click on the "How To Order" button above for complete ordering information.