

# Soft-Seal

## Tube To O-Ring Boss

### S-LGC: Long Straight Thread Connector

Connects fractional tube to female SAE/MS straight thread

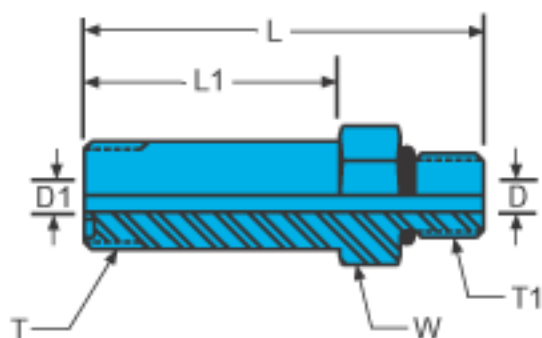

\* Working Pressures

Part Number	Tube O.D.	T Thread	T1 Thread	D Through Hole	D1 Through Hole	L	L1	W Hex	Stainless Steel*	Monel*	Brass*
S4LGC	1/4	9/16 - 18	7/16 - 20	0.172	0.172	2.07	1.33	5/8	9200	---	---
S6LGC	3/8	11/16 - 16	9/16 - 18	0.264	0.264	2.27	1.45	3/4	9200	---	---
S8LGC	1/2	13/16 - 16	3/4 - 16	0.378	0.378	2.68	1.74	7/8	9200	---	---
S10LGC	5/8	1 - 14	7/8 - 14	0.484	0.484	3.13	2.04	1-1/16	6000	---	---
S12LGC	3/4	1-3/16 - 12	1-1/16 - 12	0.609	0.609	3.76	2.05	1-5/16	6000	---	---
S16LGC	1	1-7/16 - 12	1-5/16 - 12	0.812	0.812	4.14	2.85	1-5/8	6000	---	---
S20LGC	1-1/4	1-11/16 - 12	1-5/8 - 12	1.024	1.024	4.76	3.39	1-7/8	4000	---	---
S24LGC	1-1/2	2 - 12	1-7/8 - 12	1.260	1.260	5.26	3.82	2-1/8	4000	---	---